

DelStar[®]

HD Brushless

Series 160

SERVICE PARTS

EXPLODED VIEW
for J180 4" Hinge & PAD Mount







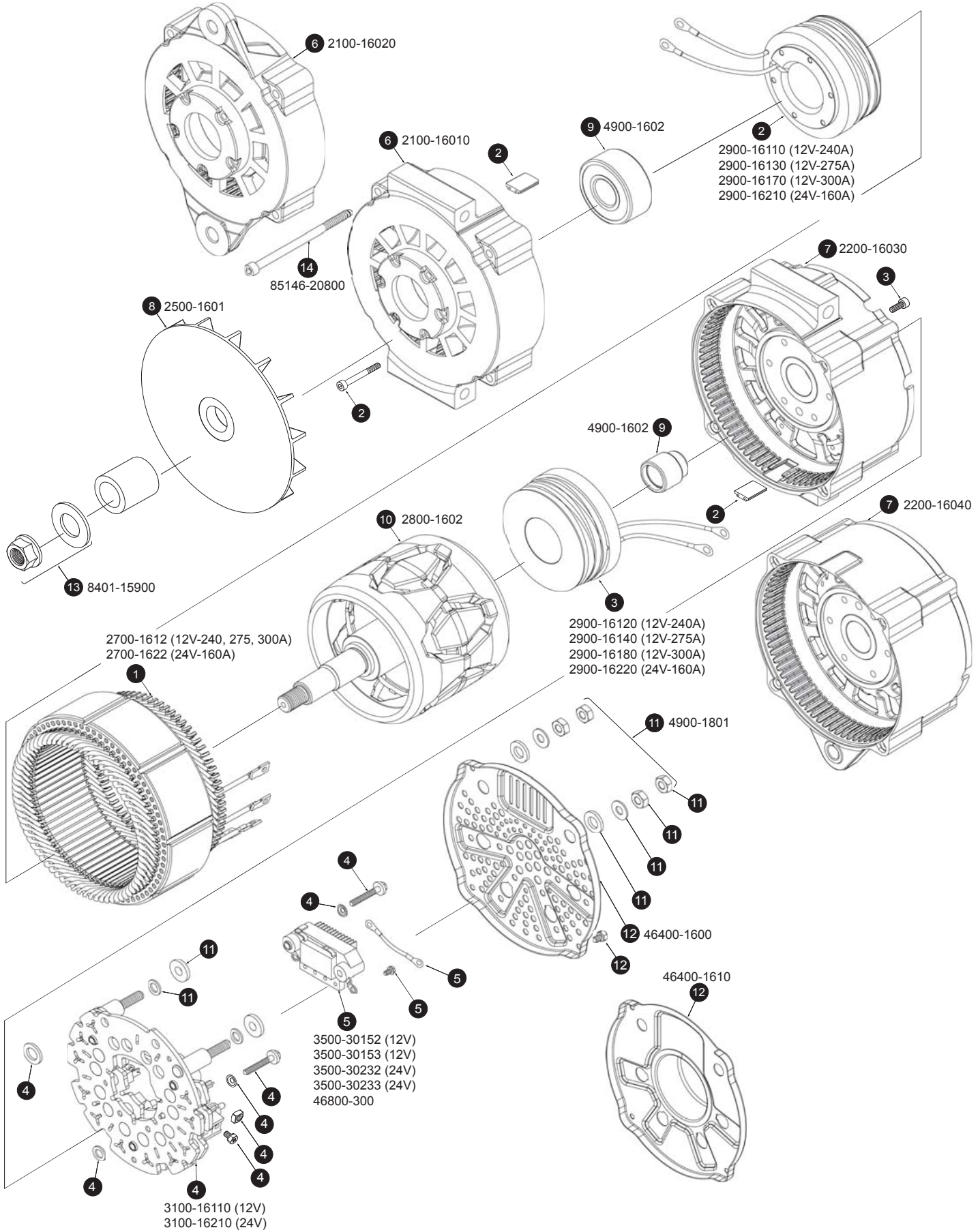

Series 160

9800-DELS-160
160519

HD Brushless

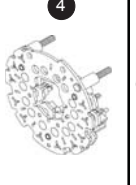
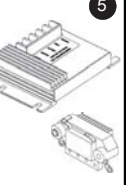
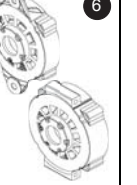

MAJOR COMPONENTS

								
MODEL No.	V-Amp @ 2000 / 5000 RPM	STATOR ASSY.	FRONT COIL PKG.	REAR COIL PKG.	RECTIFIER PKG.	REGULATOR OR TERM. BLOCK	FRONT HOUSING ASSY. <small>Includes Bearing</small>	REAR HOUSING ASSY. <small>Includes Bearing</small>

100-16101	12V 135 / 275A	2700-1612	2900-16130	2900-16140	3100-16110	3500-30152 3500-30153	2100-16020	2200-16040
100-16102	12V 140 / 300A	2700-1612	2900-16170	2900-16180	3100-16110	3500-30152 3500-30153	2100-16020	2200-16040
100-16103	12V 126 / 240A	2700-1612	2900-16110	2900-16120	3100-16110	3500-30152 3500-30153	2100-16020	2200-16040
100-16106	12V 126 / 240A	2700-1612	2900-16110	2900-16120	3100-16110	3500-30152 3500-30153	2100-16020	2200-16040
100-16107	12V 135 / 275A	2700-1612	2900-16130	2900-16140	3100-16110	3500-30152 3500-30153	2100-16020	2200-16040
100-16108	12V 140 / 300A	2700-1612	2900-16170	2900-16180	3100-16110	3500-30152 3500-30153	2100-16020	2200-16040
100-16111	12V 135 / 275A	2700-1612	2900-16130	2900-16140	3100-16110	3500-30152 3500-30153	2100-16010	2200-16030
100-16112	12V 140 / 300A	2700-1612	2900-16170	2900-16180	3100-16110	3500-30152 3500-30153	2100-16010	2200-16030
100-16113	12V 126 / 240A	2700-1612	2900-16110	2900-16120	3100-16110	3500-30152 3500-30153	2100-16010	2200-16030
100-16116	12V 126 / 240A	2700-1612	2900-16110	2900-16120	3100-16110	3500-30152 3500-30153	2100-16010	2200-16030
100-16117	12V 135 / 275A	2700-1612	2900-16130	2900-16140	3100-16110	3500-30152 3500-30153	2100-16010	2200-16030
100-16118	12V 140 / 300A	2700-1612	2900-16170	2900-16180	3100-16110	3500-30152 3500-30153	2100-16010	2200-16030
100-16206	24V 85 / 160A	2700-1622	2900-16210	2900-16220	3100-16210	3500-30232 3500-30233	2100-16020	2200-16040
100-16216	24V 85 / 160A	2700-1622	2900-16210	2900-16220	3100-16210	3500-30232 3500-30233	2100-16010	2200-16030

Items 8 through 14, please refer to next the page.

COMPONENTS LISTING

ITEM	PART No.	DESCRIPTION
1	2700-1612	STATOR ASSY., 160 (12V-240, 275, 300A) HP
1	2700-1622	STATOR ASSY., 160 (24V-160A) HP
2	2900-16110	COIL PKG., 160 Front (12V-240A)
2	2900-16130	COIL PKG., 160 Front (12V-275A)
2	2900-16170	COIL PKG., 160 Front (12V-300A)
2	2900-16210	COIL PKG., 160 Front (24V-160A)
3	2900-16120	COIL PKG., 160 Rear (12V-240A)
3	2900-16140	COIL PKG., 160 Rear (12V-275A)
3	2900-16180	COIL PKG., 160 Rear (12V-300A)
3	2900-16220	COIL PKG., 160 Rear (24V-160A)
4	3100-16110	RECTIFIER PKG. 160, 161 (12V)
4	3100-16210	RECTIFIER PKG. 160, 161 (24V)
5	3500-30152	V. REGULATOR PKG., 14.2 V. Set
5	3500-30153	V. REGULATOR PKG., 14.2 V. Set (Adjustable)
5	3500-30230	V. REG. PKG., Used w/ Diode Trio type Rectifier
5	3500-30232	V. REGULATOR PKG., 28.0 V. Set

ITEM	PART No.	DESCRIPTION
5	3500-30233	V. REGULATOR PKG., 28.0 V. Set (Adjustable)
5	3501-5014	V. REGULATOR, 14.2 V. Set (Adjustable) Firewall Mounted
5	3500-50251	V. REGULATOR, 28.0 V. Set (Adjustable) Firewall Mounted
5	46800-300	TERMINAL BLOCK CONNECTOR PKG.
6	2100-16010	HOUSING ASSY. 160, 161 Front, PAD
6	2100-16020	HOUSING ASSY. 160, 161 Front, J180
7	2200-16030	HOUSING ASSY. 160 Rear, PAD (Dual Coil)
7	2200-16040	HOUSING ASSY. 160 Rear, J180 (Dual Coil)
8	2500-1601	FAN, 160 (Directional CW)
9	4900-1602	BEARING KIT 160, 161 Series
10	2800-1602	ROTOR ASSY., 160 Series (Dual rotor)
11	4900-1801	HARDWARE PKG.
12	46400-1600	COVER PLATE PKG. 160, 161
12	46400-1610	COVER PLATE PKG. 160, 161 with 2.00" Ø air intake
13	8401-15900	PULLEY NUT PKG., (5/8-18 Thread)
14	85146-20800	THRU-BOLT PKG. (M6 X 1.0 X 80mm L)

Corporate Headquarters Manufacturing and Distribution

Dixie Electric Ltd.
517 Basaltic Road
Concord, ON. Canada L4K 4W8
Tel.: 905-879-0533 Fax: 905-879-0532
U.S. 800-563-3933
E-Mail: sales@dixie-electric.com
Web Site: www.dixie-electric.com



USA Sales and Distribution

Dixie Electric Inc.
17100 Medina Road, Suite 100
Minneapolis, MN. U.S.A. 55447-1249
Tel.: 763-475-6629 800-478-0608
Fax: 763-475-6635 800-392-8719
E-Mail: mn.sales@dixie-electric.com
Web Site: www.dixie-electric.com